



CHARN.ENT.52MM INSER. 0MM C2W6A99

SALICE

Réf. : SAL500

Page catalogue : 952

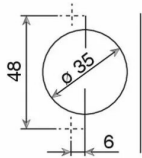

Entraxe 48 mm



A visser

SALICE

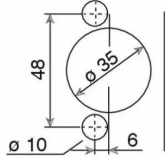

Entraxe 48 mm

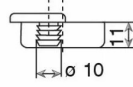

A enfoncer

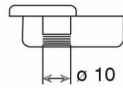

Nuovo rapido

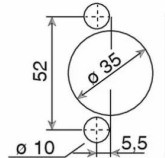

Entraxe 52 mm

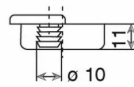

A enfoncer

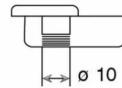

Nuovo rapido

Vendu par

1

300

Finition : acier nickelé. Montage : par glissement ou par clipsage.

Réglage recouvrement : sur charnière - 1,5 / + 4,5 mm.

Réglage haut. : sur embase - 2,0 / + 2,0 mm. Réglage prof. : sur embase + 2,8 mm.

Boîtier A enfoncer

Entraxe 52 mm

Ouverture 110°